



TECHNICAL DATA

Technical data # 104-163/304

NAME OF PRODUCT

PRODUCT NO.

«**SUPRA EXPERT**»
THERMOPLASTIC SEALANT FOR PROFESSIONAL USERS

104 XX0

DESCRIPTION

Super-durable thermoplastic architectural one component sealing compound for exterior multipurpose. Dries by solvent evaporation.

INTENDED USES

«**SUPRA EXPERT**» is formulated to seal outdoor joints between two perpendicular surfaces exposed to thermal movement around door and window frames and sidings.

Super adhesion on many surfaces such as: concrete, masonry, painted or stained woods, natural, painted or anodized aluminum, vinyl siding or windows, steel, metal, glass and fiberglass.

The performance of «**SUPRA EXPERT**», its ease of use as well as its remarkable choice of colors make it the ideal choice for professionals in construction and renovation applications.

REMARKS: not to be used on insulating panels or plastic materials which can be affected by solvents; does not withstand immersion (tanks) or abrasion (foot traffic).

ADVANTAGES

- ⇒ Professional quality with excellent life expectancy.
- ⇒ Free of air bubbles (1).
- ⇒ Multipurpose use with a super adhesion on many construction materials, including glass.
- ⇒ Ease of application without normal need of primer.
- ⇒ Rapid skin formation on which dust will not adhere.
- ⇒ Can be applied on vertical, horizontal or overhanging surfaces without subsiding or sagging.
- ⇒ No staining of surrounding surfaces.
- ⇒ Remains flexible with a superior and permanent elasticity up to – 40°C (– 40°F).
- ⇒ Can be stretched out to 1400 % (ASTM D-412) without breaking.
- ⇒ Does not require painting, however it can be painted over 24 hours after application (latex paint).
- ⇒ Withstands weathering ultraviolet and exterior temperature changes.

(1) REMARKS: Due to the **Mulco's** expertise with the thermoplastic sealants, «**SUPRA EXPERT**» is manufactured, put in cartridges, stored and delivered to our customers in such a way that the paste is free of air bubbles and is extruded uniformly and constantly. However, it happens sometimes that absorbing or porous surfaces cause the appearance of bubbles in the joint of the sealant during its drying.

STORAGE AND APPLICATION TEMPERATURE

«**SUPRA EXPERT**» does not deteriorate below freezing point. Nevertheless, since its viscosity increases during the lowering of its temperature, it is recommended to store it in a dry place whose temperature is between 10°C (50°F) and 30°C (86°F). Thus, the sealed cartridges could be preserved for 3 years.

«**SUPRA EXPERT**» can be applied in winter as well as in summer. However, the product's temperature must be above 5°C (40°F) to be applied easily.

SURFACE PREPARATION

There must be a free space between the two materials to permit their dimensional variations. Once applied, the sealant caulks the aperture. It will get compressed or stretched out depending on the movement of the materials.

To determine the size of the joint, one must take into consideration the expansion or the contraction the materials will be subjected to with the temperature or humidity variations. It must also be noted that some materials have greater dimensional variations than others.

If possible, apply «**SUPRA EXPERT**» whenever the size of the aperture between the materials is in-between.

SURFACE PREPARATION (continued)

When the joint covers an aperture of 6 mm (1/4 in.) or larger, the joint must be sustained by a backing rod in polyethylene. The diameter of the backing rod must be approximately 3 mm (1/8 in.) wider than the width of the joint to permit compression.

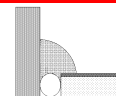

New metal and solvent resistant oily surfaces must be washed with acetone and dried up. Scrape rusty metal with a metallic brush prior to cleaning.

Surfaces sensitive to solvents such as vinyl or dirty plastic materials must be washed out with a soapy solution, then rinsed and dried up.

Concrete and masonry must be scraped with a metallic brush so as to get a sound, firm, clean, stainless surface.

If the application of «SUPRA EXPERT» is to be made at a temperature lower than 5°C (40°F), the surface must be at a temperature at least 3°C (5°F) higher than dew point. The surfaces must be free of frost or ice.

If an old sealant or putty is present, they must be taken off. The surface must be in a seemingly new, firm and clean state. It must also be free of creosote, oil, grease, wax, silicone or silicone based product or asphalt or bitumen based product (coating, adhesive and so on), rust, any loose or foreign material or any material soluble in solvents.

RECOMMENDED PRIMER

No primer normally required.

DIRECTIONS FOR USE

Cut the nozzle of the cartridge at right angle (90°), a little narrower than the width of the desired joint. Pierce the aluminum patch sealing the cartridge inside the nozzle.



Use a caulking gun and apply with a uniform and adequate pressure so as to give the joint a convex form. «SUPRA EXPERT» must not be smoothed or formed. That will provoke tensions in the product during drying time.

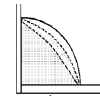

During the extrusion of «SUPRA EXPERT», the angle between the gun and the joint to be made must be approximately 45°. Pull the tip of the gun away from the joint, as illustrated.

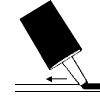

Make sure the sealant comes into contact with each of the surfaces on a width at least 3 mm (1/8 in.).

Example of minimal required widths for «SUPRA EXPERT» joints with various exterior materials per 10 feet lengths:

Steel, aluminum, concrete and painted or stained wood:	1/4 in.	(6 mm)
Brick or masonry:	1/4 in.	(6 mm)
Vinyl (PVC):	1/2 in.	(12 mm)

COVERAGE

Linear meters per cartridge:							Linear feet per cartridge:				
depth (mm)	6	8	10	12	14	16	depth (in.)	1/4	3/8	1/2	5/8
width (mm) 6	11	8	6,4	5,3	4,5	4	width (in.) 1/4	31	20,7	15,5	12,4
8	8	6	4,8	4	3,4	3	3/8	20,7	13,8	10,3	8,3
10	6,4	4,8	3,8	3,2	2,7	2,4	1/2	15,5	10,3	7,7	6,2
12	5,3	4	3,2	2,7	2,3	2	5/8	12,4	8,3	6,2	5

PHYSICAL PROPERTIES

GENERAL APPEARANCE:	homogeneous paste, free of lumps and easy to extrude.
COLORS:	consult our color chart.
COMPOSITION:	thermoplastic rubber, synthetic resins (binder), titanium dioxide (clear excepted), color pigments (clear excepted), no inert charge (pigment), promoter of adhesion (agents), solvents (volatile material) and other additives.
WHIMS CLASSIFICATION:	B4 D2A; product for industrial use only, non-professional customer must use FLEXTRA or FLEX 9000.
CLEANING AGENT (before drying):	use mineral spirits.
CLEANING AGENT (dried product):	use a putty knife and mineral spirits or other effective solvent (too strong solvent may damaged other surfaces).
CLEANING AGENT (skin contact):	wash immediately with mineral oil and then wash carefully with soap and water.
FLAMMABILITY:	at application: flammable; dry: combustible.
FREEZE THAW STABILITY:	«SUPRA EXPERT» will not be damaged by the frost.
VISCOSITY:	1 000 000 CPS.

PHYSICAL PROPERTIES (continued)

APPLICATION METHOD:	manual or pneumatic caulking gun.	
APPLICATION SURFACE:	vertical or horizontal joints.	
APPLICATION SITE:	exterior joints.	
EASE OF APPLICATION:	CAN/CGSB-19.0-M77 method 3.1:	400 g/min. (easy).
MINIMUM APPLICATION TEMPERATURE:	surface:	- 30°C (-22°F);
	product:	5°C (40°F).
MAXIMUM APPLICATION TEMPERATURE:	surface:	40°C (100°F);
	product:	30°C (86°F).
DIMENSION:	minimum:	6 mm (1/4 in.);
	maximum:	16 mm (5/8 in.).
BLEEDING OF SEALING COMPOUNDS:	CAN/CGSB-19.0-M method 9.2	pass (does not bleed).
VERTICAL JOINT SAGGING:	CAN/CGSB-19.0-M method 7.1	less than 5 mm.
STANDARDS:	though no standard presently exists for thermoplastic rubber-based sealants, «SUPRA EXPERT» surpasses the elasticity and adhesion traction criteria after cyclical treatment of ONGC standards: 19-GP-5M (acrylic and solvent). 19-GP-14M (butyl); CAN/ONGC-19.13-M87 (category 25) (silicone, polyurethane, polysulfide, 1 part); CAN/ONGC-19.17-M90 (acrylic latex); CAN/ONGC-19.24-M90 (silicone, polyurethane, polysulfide 2 parts).	
DENSITY:	0.98 kg/litre.	
SERVICE TEMPERATURE:	minimum:	-40°C (-40°F);
	maximum:	50°C (122°F).
HARDNESS (shore A):	CAN/CGSB-19.0-M77 method 8.2	40.
ELONGATION BEFORE RUPTURING:	ASTM D-412	1400 %.
LOW TEMPERATURE FLEXIBILITY:	CAN/CGSB-19.0-M77 method 14.6	pass -30°C (-22°F).
TENSION STRENGTH:	ASTM D-412	3 M Pa. (435 psi.).
ADHESION PEEL STRENGTH:	CAN/CGSB-19.0-M77 method 14.6	
	Aluminum	8,1 KN/m;
	Glass	7.4 KN/m;
	Concrete:	7.9 KN/m.
UV RESISTANCE:	ASTM C-793	excellent.

RESTRICTIONS

Make sure the joint variation does not exceed the «SUPRA EXPERT» elasticity.

The drying time of «SUPRA EXPERT» depends on temperature, relative humidity and ventilation.

The shelf life is diminished by warehousing over 25°C (77°F).

Not for joints submerged in water for prolonged periods of time.

Adhesion on material not specifically mentioned cannot be guaranteed. It is up to the customer to make his own performance tests or to consult our technical department.

SAFETY MEASURES

KEEP OUT OF THE REACH OF CHILDREN.

Before using «SUPRA EXPERT», consult the product material safety data sheet (MSDS).

Avoid using in areas where the solvents evaporating from «SUPRA EXPERT» could affect food or inside residences where sensitive people are present.

If the product is used indoors (factory), the area must be ventilated to the outdoors during application and drying time of «SUPRA EXPERT».

«SUPRA EXPERT» contains flammable solvents. Do not smoke when using the product. Work in good ventilation conditions. Suppress all flash sources, flames or intense heat at the working place and near it.

Disposal: consult your municipality to dispose in conformity with regulations.